

RICHARDS
15KV

CONNECTOR 1/0 AWG
RICHARDS P6AL-9

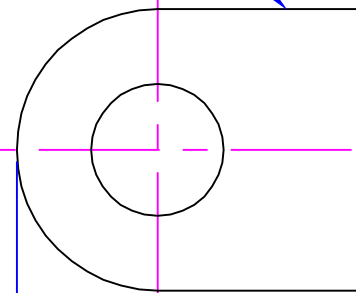

2.72" [2 3/4"]

9.77" [9 3/4"]

4-4 PRE-SWAGE (IA)
INJECTION ADAPTER

INSULATION
220 MILS

**INSULATION CUT
BACK TEMPLATE**

SEMI-CON SHIELD

TOOL STOP

6.36" [6 3/8"]

10.77" [10 3/4"]

4.44" [4 7/16"]

MARKING TAPE

RICHARDS 62LCN1 or 62LCT1

SEMI-CON SHIELD

CABLE INSULATION ADAPTER
RICHARDS P625CA-G

**TOOL STOP CUT
BACK TEMPLATE**

**NOTE, THE INSULATION ADAPTER MUST
BE ON THE CABLE BEFORE SWAGING THE
CONNECTOR. SEE NRI 31 & NRI 32**

The marking tape must be located from end of strip cable (as shown as pre-swage) to end of cable insulation adapter and should be within 1/4" inch [6mm] after swage.

RCH-15 62LC(N-T)1-G 10 4-4 26mar10

© Copyright 2007, Novinium, Inc. All rights reserved.
IA is protected by patents and patents pending
Novinium is a registered trademark of Novinium.
(Printing Instructions: For best results, print in color, protect w/5mil laminate and trim to size.)

novinium

SCALE: 1:1 8.5 x 22 paper size